

Window Box Card

You will need:

- Whisper White Card Stock 3 7/8" x 3.5"
- Whisper White Card Stock 5" x 3" scored at .25" and 4.75"
- Whisper White Card Stock 3.5" x 3.5"
- Whisper White Card Stock 4" x 4.25"
- Night of Navy Card Stock 4.25" x 11"
- Scrap of any yellow Card Stock 1.5" x 3"

Hometown Greeting Edgelits Dies #144671
 Layering Squares Framelits Dies #141708



Using 3 7/8" x 3.5" take the die with 3 houses one tree and place at top of card stock as shown, run through die cut machine

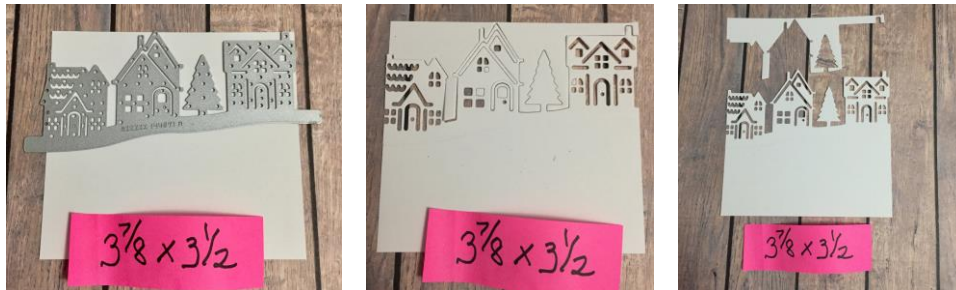

Using 5" x 3" take die with snowman and place in center cardstock aligning the die at the left edge of the paper and the 2nd score line. (You will be cutting off the left house after you run it thru your machine)



Using 3.5" x 3.5" take the die with Church and align left end of die with left side of paper placing about 1" inch from bottom and making sure Church Steeple is about 3/8" from top. Trim off tree on the right end



I wanted the Church to look like all the lights were on and I did this by one of 2 ways. Either trace the Church or use the negative space as a template!

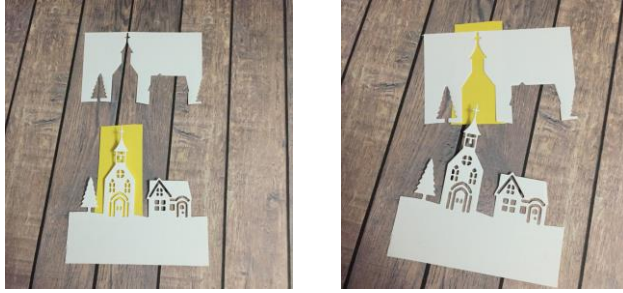

Cut within the traced line and adhere to backside of the church.

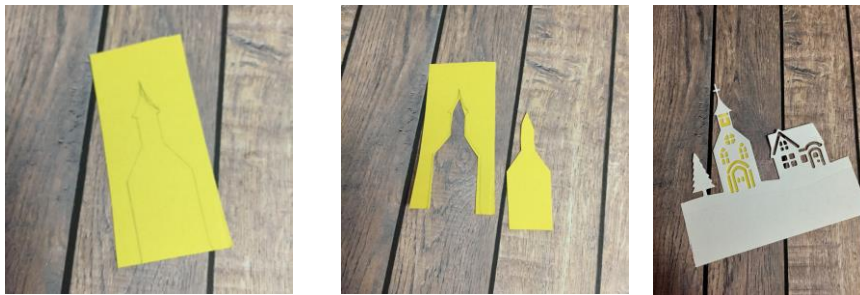

Night of Navy Card Stock 4.25" x 11" Score at .5", 4.5", 5 3/4" and 9 3/4"



Using the largest of the layering square framelets place in center of the panel between the 1.25 scorelines

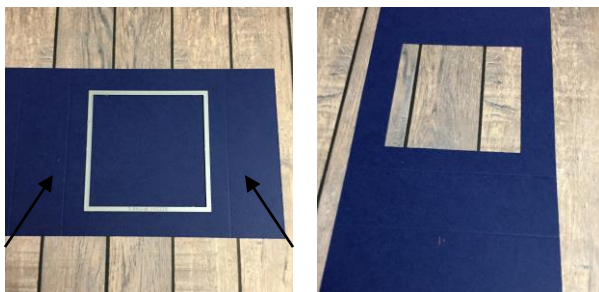

Next, using the “stars and snow” die from the Hometown greetings create your night Sky. Be sure to have the ¼” score line to the right and add one row across the top on the large portion that is still uncut.



Now it is time to assemble our card. I have a short tutorial on YouTube that will guide you step by step. This is the link to the tutorial: https://youtu.be/_vylGLonuhM

Starting with the center (snowman panel) crease your score lines, one mountain, the other valley. Adhere your right mountain fold to the 1.25 inch fold line closest to “stars”/ once adhered, lie you card flat and adhere valley fold to left. This should attach nicely when you fold it. Clear as mud? Please watch the video, sometimes its easier to see it in action!

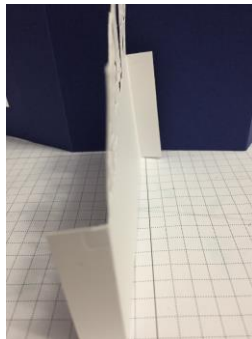

Next adhere the panel with the 3 houses and the tree below the stars and adhere the Church panel behind your Square opening.

Form your “box” by adhering adhesive to the ¼” fold and attach to inside of the opposite fold. You should now be able to fold your card to the left or the right.

Finally, adhere a 4” x 4.25” white Card Stock panel to the back of your card. This allows you to write or stamp your sentiment and also creates the White stars and snow in your scene!

